

**VENTAFLEX®**

More efficiency in air conduction

# VENTAFLEX®: Heat exchanger

## Air-water heat exchanger for an efficient heat transmission



### Horizontal circulation of the air

The air is sucked in sideways. An application is made in very long halls, in doing so the supply air gets to the long side of the hall. Overall the construction is

resistant, because it is solely made of non-corrosive stainless steel and plastic materials with smooth surfaces, which are easy to clean.

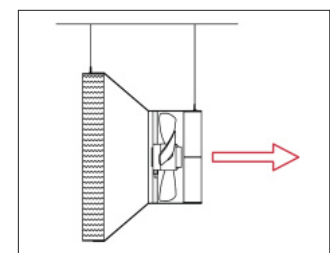
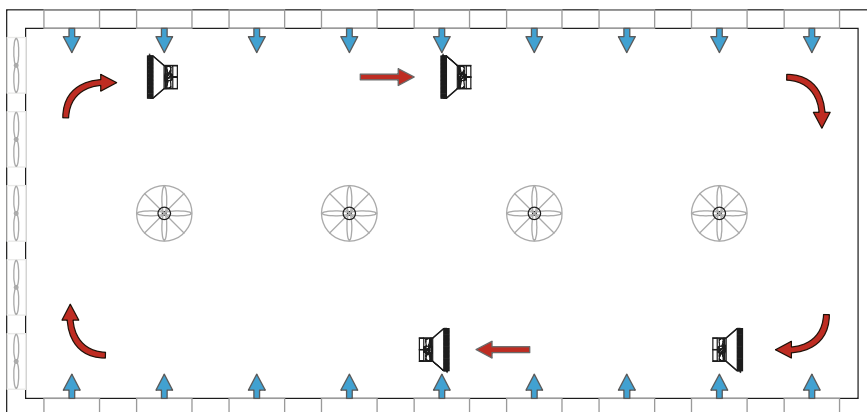

# Air heater – horizontal installation position



**Type 2 H - Stainless steel “sucking”**

**Type 2 H - Stainless steel “pressing”**

Air performance 3.000 m<sup>3</sup>/h  
Heat: 30 kW bei 20°C Room temperature  
horizontal air guidance

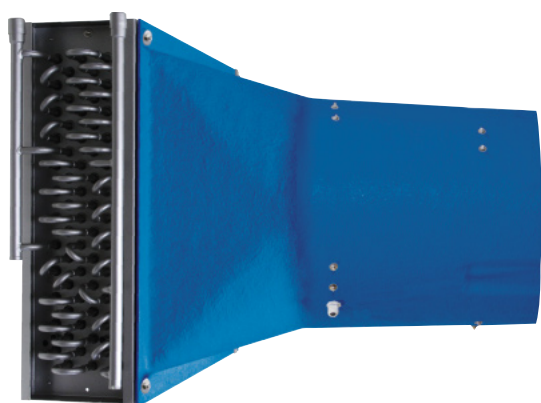

**Type 3 H - Stainless steel “sucking”**

**Type 3 H - Stainless steel “pressing”**

Air performance 5.000 m<sup>3</sup>/h  
Heat: 50 kW bei 20°C Room temperature  
horizontal air guidance

**Type 4 H - Stainless steel “sucking”**

Air performance 7.500 m<sup>3</sup>/h  
Heat: 95 kW bei 20°C Room temperature  
horizontal air guidance

“sucking”

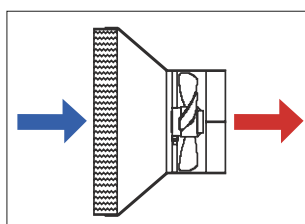

High air velocity for high throwing distance

“pressing”

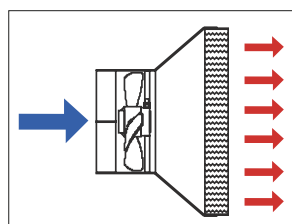

Low air velocity in the entrance room and for small compartments

| type    | version  | item no. |
|---------|----------|----------|
| Typ 2 H | sucking  | 281100   |
|         | pressing | 281130   |
| Typ 3 H | sucking  | 281200   |
|         | pressing | 281230   |
| Typ 4 H | sucking  | 281300   |

**Technical data**

|  | type 2 H               | type 3 H               | type 4 H               |
|--|------------------------|------------------------|------------------------|
| Fan capacity                             | 3000 m <sup>3</sup> /h | 5000 m <sup>3</sup> /h | 7500 m <sup>3</sup> /h |
| Connection value fan                     | 400V; 0,75A; 350W      | 400V; 1,1A; 530W       | 400V; 1,25A; 630W      |
| Air inlet dry                            | 20°C                   | 20°C                   | 20°C                   |
| Air outlet dry                           | 50°C                   | 48,9°C                 | 56,9°C                 |
| Air pressure drop dry                    | 42 Pa                  | 47 Pa                  | 56 Pa                  |
| Heating medium flow-/ return temperature | 80/60 °C               | 80/60 °C               | 80/60 °C               |
| Water pressure drop                      | 0,34 bar               | 0,49 bar               | 0,36 bar               |
| Water flow rate                          | 1,34 m <sup>3</sup> /h | 2,15 m <sup>3</sup> /h | 4,11 m <sup>3</sup> /h |
| Performance at 20°C room temperature     | ~ 30 KW                | ~ 50 KW                | ~ 95 KW                |
| Dimension air heater H x B x T           | 700 x 700 x 896 mm     | 800 x 900 x 976 mm     | 1000 x 1100 x 1075 mm  |
| Connection pipe thread                   | 3/4"                   | 3/4"                   | 1"                     |
| item no. Horizontal stainless steel      | 281100 / 281130        | 281200 / 281230        | 281300 / 281330        |

**Weight "sucking"**

| type       | item no. | empty weight (kg) | water content (kg) | total weight (kg) |
|------------|----------|-------------------|--------------------|-------------------|
| Typ 2 H/A2 | 281100   | ca. 50            | 5,9                | ca. 56            |
| Typ 3 H/A2 | 281200   | ca. 66            | 8,1                | ca. 74            |

**Weight "pressing"**

| type       | item no. | empty weight (kg) | water content (kg) | total weight (kg) |
|------------|----------|-------------------|--------------------|-------------------|
| Typ 2 H/A2 | 281130   | ca. 47            | 5,9                | ca. 53            |
| Typ 3 H/A2 | 281230   | ca. 59            | 8,1                | ca. 67            |
| Typ 4 H/A2 | 281330   | ca. 92            | 17,6               | ca. 110           |

**Dimensions "sucking"**

| type    | H (mm) | B (mm) | T (mm) | D (mm) |
|---------|--------|--------|--------|--------|
| Typ 2 H | 700    | 700    | 896    | 445    |
| Typ 3 H | 800    | 900    | 976    | 498    |
| Typ 4 H | 1000   | 1100   | 1075   | 632    |

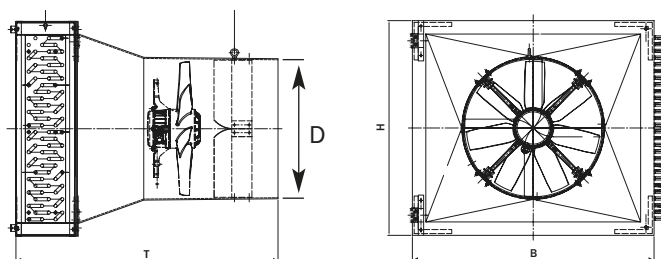
**Dimensions "pressing"**

| type    | H (mm) | B (mm) | T (mm) | D (mm) |
|---------|--------|--------|--------|--------|
| Typ 2 H | 680    | 700    | 678    | 462    |
| Typ 3 H | 780    | 900    | 690    | 525    |

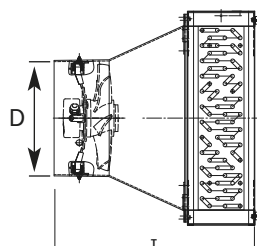

**VENTAFLEX®**  
More efficiency in air conduction