

VENTAFLEX®

More efficiency in air conduction

VENTAFLEX®: Heat exchanger

Air-water heat exchanger for an efficient heat transmission



Horizontal circulation of the air

The air is sucked in sideways. An application is made in very long halls, in doing so the supply air gets to the long side of the hall. Overall the construction is

resistant, because it is solely made of non-corrosive stainless steel and plastic materials with smooth surfaces, which are easy to clean.

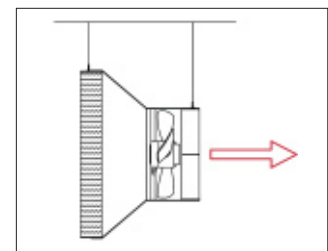
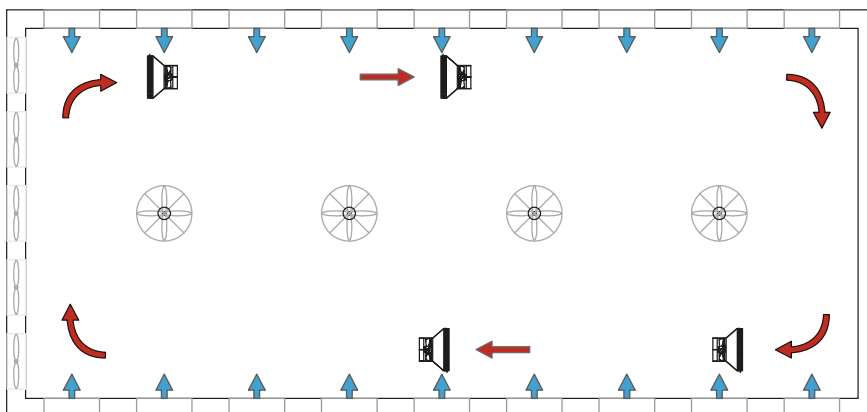

Air heater – horizontal installation position



Type 2 H - Stainless steel “sucking”

Type 2 H - Stainless steel “pressing”

Air performance 3.000 m³/h
Heat: 30 kW bei 20°C Room temperature
horizontal air guidance

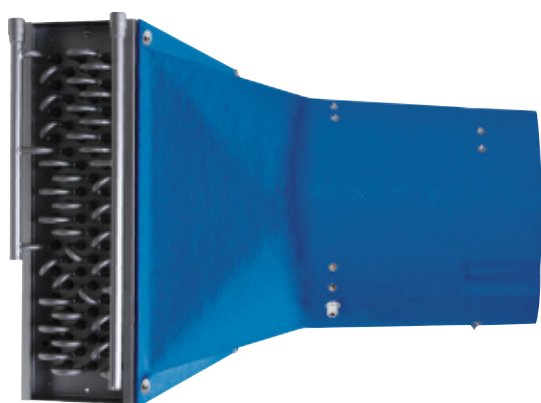

Type 3 H - Stainless steel “sucking”

Type 3 H - Stainless steel “pressing”

Air performance 5.000 m³/h
Heat: 50 kW bei 20°C Room temperature
horizontal air guidance

“sucking”

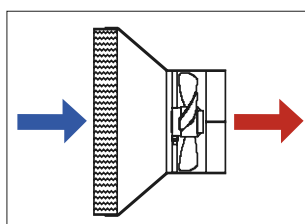

High air velocity for high throwing distance

“pressing”

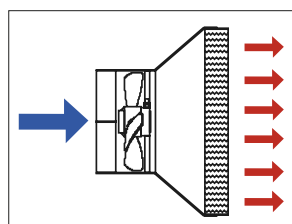

Low air velocity in the entrance room and for small compartments

Type 4 H - Stainless steel “sucking”

Air performance 7.500 m³/h
Heat: 95 kW bei 20°C Room temperature
horizontal air guidance

type	version	item no.	price € /per piece
Typ 2 H	sucking	281100	3098,80
	pressing	281130	3098,80
Typ 3 H	sucking	281200	3592,70
	pressing	281230	3592,70
Typ 4 H	sucking	281300	5307,40

Technical data

	type 2 H	type 3 H	type 4 H
Fan capacity	3000 m ³ /h	5000 m ³ /h	7500 m ³ /h
Connection value fan	400V; 0,75A; 350W	400V; 1,1A; 530W	400V; 1,25A; 630W
Air inlet dry	20°C	20°C	20°C
Air outlet dry	50°C	48,9°C	56,9°C
Air pressure drop dry	42 Pa	47 Pa	56 Pa
Heating medium flow-/ return temperature	80/60 °C	80/60 °C	80/60 °C
Water pressure drop	0,34 bar	0,49 bar	0,36 bar
Water flow rate	1,34 m ³ /h	2,15 m ³ /h	4,11 m ³ /h
Performance at 20°C room temperature	~ 30 KW	~ 50 KW	~ 95 KW
Dimension air heater H x B x T	700 x 700 x 896 mm	800 x 900 x 976 mm	1000 x 1100 x 1075 mm
Connection pipe thread	3/4"	3/4"	1"
item no. Horizontal stainless steel	281100 / 281130	281200 / 281230	281300 / 281330

Weight "sucking"

type	item no.	empty weight (kg)	water content (kg)	total weight (kg)
Typ 2 H/A2	281100	ca. 50	5,9	ca. 56
Typ 3 H/A2	281200	ca. 66	8,1	ca. 74

Weight "pressing"

type	item no.	empty weight (kg)	water content (kg)	total weight (kg)
Typ 2 H/A2	281130	ca. 47	5,9	ca. 53
Typ 3 H/A2	281230	ca. 59	8,1	ca. 67
Typ 4 H/A2	281330	ca. 92	17,6	ca. 110

Dimensions "sucking"

type	H (mm)	B (mm)	T (mm)	D (mm)
Typ 2 H	700	700	896	445
Typ 3 H	800	900	976	498
Typ 4 H	1000	1100	1075	632

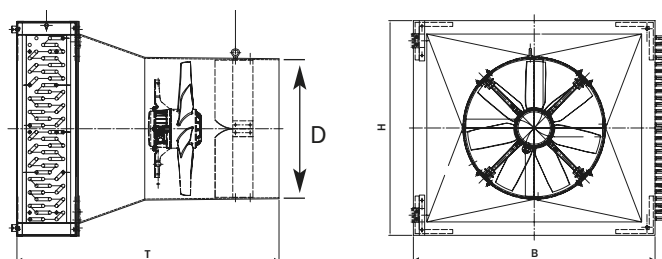
Dimensions "pressing"

type	H (mm)	B (mm)	T (mm)	D (mm)
Typ 2 H	680	700	678	462
Typ 3 H	780	900	690	525

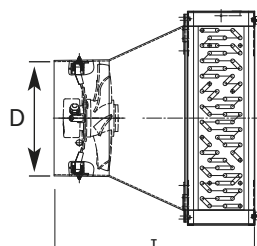

VENTAFLEX®
More efficiency in air conduction

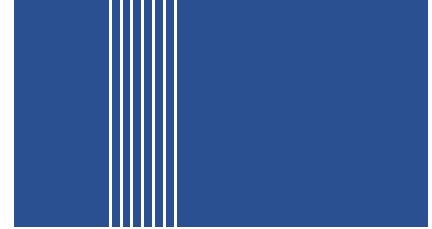
VENTAFLEX®

More efficiency in air conduction

Air heater– additional supplies

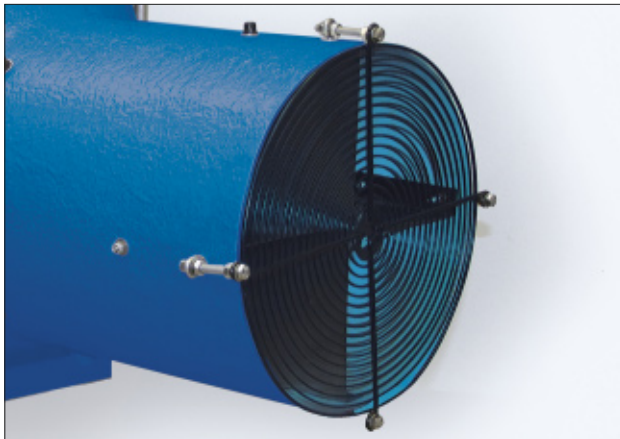

Protection grille air heater

Protection grille for air heater prevents the reaching into the rotating fan.

for type H + V	item no.	price €
25 kW	281180	96,30
40 kW	281280	103,10

VENTAFLEX GmbH & Co. KG

Siemensstraße 46

D-48341 Altenberge

Fon +49 (0) 2505 – 938290

Fax +49 (0) 2505 – 93829 -10

info@ventaflex.de
www.ventaflex.de