

VENTAFLEX® AIR DUCT OVAL

Responsibility

The installation instruction for VENTAFLEX® products are a non-binding recommendation which is not legally binding. They are based on construction data and installation experience. An overall responsibility for the system on the part of VENTAFLEX® is not possible, because it solely develops, produces and delivers components and modules for the preparation of ventilation- and heating systems.

Please read this installation instruction carefully before starting the installation und make sure that all necessary materials and tools are ready to be used.

Safety note

Installation work may only be done by skilled workers who have sufficient knowledge in

- safety regulations
- accident prevention regulations
- guidelines and recognized rules of the technology (e.g. VDE-provisions, DIN-standards) because of their professional training, experience und instruction.

The skilled workers must

- be able to assess the assigned work, recognize possible dangers and avoid them
- be authorized to carry out the necessary work and action by those responsible for safety of the plant.

Quick help

If you have any further questions regarding the installation or other VENTAFLEX® products, please contact our hotline or call us under **+49 (0) 25 05 - 93 829 -20**. We will now lead you through the installation step by step.

You find further generally valid information about the processing of VENTAFLEX® air ducts under www.ventaflex.de

The employer or self-employed person has to make sure that industrial or commercial users of diisocyanate have completed a training for the secure use of it.

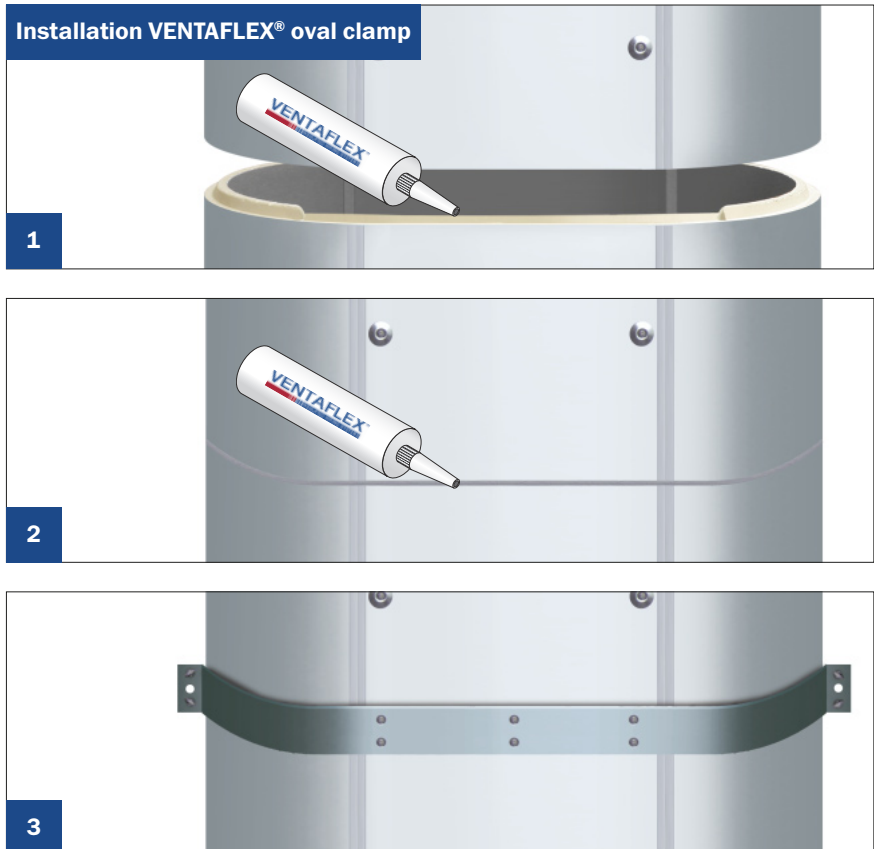
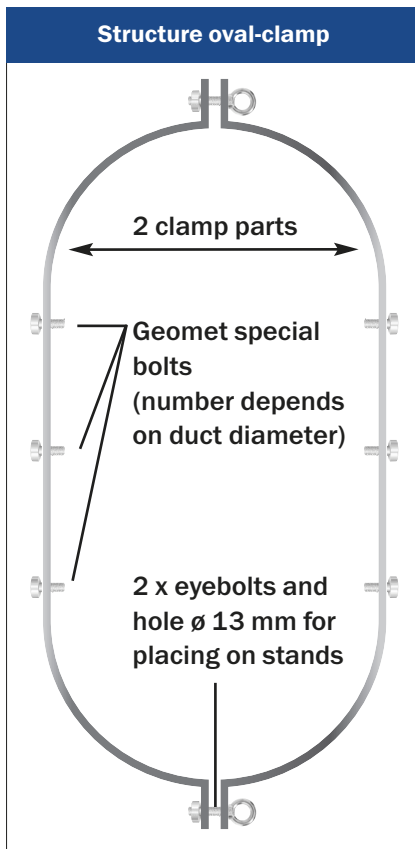

VentaRapid is a special glue for PUR rigid foam. Ideal results are reached at a processing temperature of 5°C to 35°C. Skin building time is after approx. 20 min. Indications of quantity are found on the cartridge.

Tip:

At low ambient temperature the flowability can be improved by placing the cartridges in a bucket of warm water before handling them.

Apply the glue on the different planes of the connection points. Attention has to be paid that all adhesive- and seal surfaces must be freed from dust, grease and other deposits.

The second duct is put on top of the first one until groove and tongue are joined, subsequently seal the adhesive seam with glue from the outside.

Pull the VENTAFLEX® oval-clamps only use the specifically developed Geomet special bolts to maintain the tightness of the duct.

For the mounting of the VENTAFLEX® oval-clamps only use the specifically developed Geomet special bolts to maintain the tightness of the duct.

VENTAFLEX GmbH & Co. KG

Siemensstraße 46

D-48341 Altenberge

Fon +49 (0) 2505 – 938290

Fax +49 (0) 2505 – 93829 -10

info@ventaflex.de

www.ventaflex.de